



2-4



**NO TOOLS REQUIRED**  
 Aucun outil nécessaire  
 No necesita herramientas  
 kein Werkzeug notwendig  
 Geen gereedschap nodig  
 Attrezzi non necessari  
 Bez u ycia narz dzi



**SETUP TIME**  
 Temps de montage  
 Tiempo de montaje  
 Montagezeit  
 Montagetijd  
 Tempo di montaggio  
 Czas montażu

## ITEM • Article • Artículo • Artikel • Artikel • Prodotto • Artykół

# 54171

180 x 66 cm  
 71" x 26"

TM LAY-Z-SPA™ HAVANA

6942138924305

33,16kg  
 73,10lb

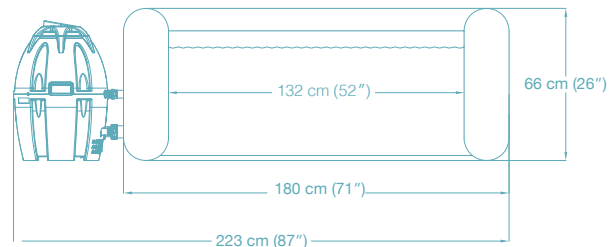
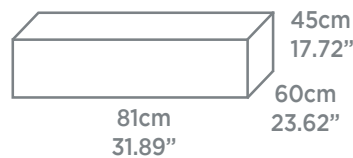

80%  
 669 L  
 177 gal.

## MATERIAL • Matériel • Material • Material • Materiaal • Materiale • Material



TRITECH™



**FOAM BOTTOM**  
 Dessous mousse  
 Parte inferior de espuma  
 Schaumstoffboden  
 Schuimbodem  
 Fondo in schiuma  
 Dno wykończone pianką



**STURDY I-BEAM CONSTRUCTION**  
 Construction robuste I-Beam  
 Estructura I-Beam resistente  
 Stabile I-Beam Konstruktion  
 Stevige I-Balk constructie  
 Robusta costruzione I-Beam  
 Przestronna konstrukcja I-Beam

## FEATURES • Caractéristiques • Características • Eigenschaften • Kenmerken • Caratteristiche • Cechy



**WATER FILTRATION**  
 Filtration de l'eau  
 Filtrado de agua  
 Wasserfilterung  
 Waterfiltratie  
 Filtrazione  
 Filtracja wody



**AIRJET™ MASSAGE SYSTEM**  
 Système de massage Airjet™  
 Sistema de masaje Airjet™  
 Airjet™-Massagesystem  
 Airjet™ - massage systeem  
 Sistema di massaggio Airjet™  
 System masujący Airjet™



**HEATING**  
 Chauffage  
 Calefacción  
 Heizfunktion  
 Verwarming  
 Riscaldamento  
 Ogrzewanie



**MAXIMUM TEMPERATURE**  
 Température maximale  
 Temperatura máxima  
 Höchsttemperatur  
 Maximum temperatuur  
 Temperatura massima  
 Temperatura maksymalna



**POWER SAVING TIMER**  
 Minuterie d'économie d'énergie  
 Temporizador de ahorro de energía  
 Energiespar-Zeitschaltuhr  
 Energiebesparende timer  
 Timer risparmio energetico  
 Energooszczędny timer

## INCLUDES • Inclus • Incluye • Inhalt • Bevat • Include • Zawiera



#58323

**CARTRIDGE**  
 Cartouche  
 Cartucho  
 Kartusche  
 Filter  
 Cartuccia  
 Wkład



**INFLATABLE COVER**  
 Bâche gonflable  
 Cubierta inflable  
 Aufblasbare Abdeckung  
 Opblaasbare afdekhoes  
 Copertura gonfiabile  
 Nadmuchiwana pokrywa



**CHEMICAL FLOATER**  
 Flotteur chimique  
 Flotador químico  
 Dosierschwimmer  
 Chemische floater  
 Galleggiante chimico  
 Floater chemiczny



for your local contact please go to:  
[www.bestwaycorp.com](http://www.bestwaycorp.com)

(+45) 69 91 15 76

[service@bestwaycorp.dk](mailto:service@bestwaycorp.dk)

## MÅLSÆTNING FOR VORES AFTER SALES SERVICE

- Hjælpe forbrugere og forhandlere
- Hjælpe kunder med deres spørgsmål om deres defekte produkter

## PRODUKTER DER ER OMFATTET AF AFTER SALES SERVICE

- |                                    |  |
|------------------------------------|--|
| • Fast Set™ poolset                | • Flowclear™ chlorinator                               |
| • Rammepool                        | • Splash in shade Play poolset                         |
| • Filter pumper                    | • Hydrium™ Steel Wall poolset                          |
| • Sandfilter                       | • Hydrium™ Splasher poolset                            |
| • El-pool varmer                   | • Stående padling                                      |
| • Lay-Z-Spa™ set                   | • Hydro-Force både (65046, 65047, 65048, 65049, 65050, |
| • Lay-Z-Spa™ underholdningsstation | 65053, 65062, 65064)                                   |
| • Sierra Ridge Air telt            | • Elektromotorer (65043, 65045)                        |

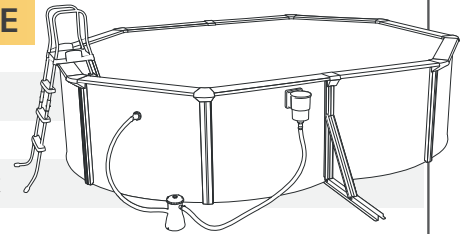

## TRE TRIN TIL AFTER SALES SERVICE

1

### KLARGØR DOKUMENTATION

Nødvendige dokumentation for oprettelse af en reklamation er følgende:

- 1) Udfyldt garantibevis (findes i brugervejledningen)
- 2) Kopi af købskvittering (MEGET VIGTIGT)
- 3) Billede af den defekte del. I visse tilfælde kan det være nødvendigt at sende den defekte del til After Sales Service.  
BEMÆRK: KUN DEFEKTE DELE UDSKIFTES
- 4) Serienummer på den defekte del.

2

### SEND REKLAMATION

Reklamationen sendes via fax eller e-mail til Bestway After Sales Center. Gå til [www.bestwaycorp.com](http://www.bestwaycorp.com) for at finde nærmeste After Sales Center.

3

### BEHANDLING AF REKLAMATION

Når reklamationen er godkendt sendes de nye dele til postadressen på garantibeviset. Forsendelsen ankommer i løbet af 4-5 arbejdsdage forudsat den indsendte dokumentation er korrekt udfyldt.



ÅBNINGSTIDER: 24 timer i døgnet året rundt



# Lay-Z-Spa™

The Comfortable, Affordable, Go-Anywhere Spa!™

## 14-Steps to Maintain Your Lay-Z-Spa™

Congratulations on the purchase of your new Lay-Z-Spa™. Before operating the Lay-Z-Spa™ be sure to follow these 14 steps. Damage resulting from misuse is not covered by the manufacturer's warranty.

1



The Lay-Z-Spa™ should not be setup or left out in temperatures lower than 4°C (40°F).

2



The PRCD must be tested before each use.

3



Fill the water level between maximum and minimum printed on the SPA wall.

4

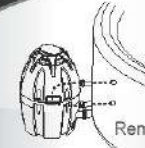

Remove Stopper Caps  
Ensure water is circulating between the Spa and the Pump and that the Stopper Caps have been removed.

5



Be sure to set your desired temperature.



11

### Hibernate Function:

After 72 hours of operation (except timer function), the pump will hibernate and "END" will be display on the LED. When the pump is hibernating both the rapid heating and water filtration functions are disabled. To re-activate the pump simply press any button on the control panel.



12

**IMPORTANT NOTICE:**  
This unit will auto lockout after 5 minutes of inactivity. To **W/A** simply place a finger over function button for 3 seconds.

13



We recommend you take a shower before using your Lay-Z-Spa, as cosmetic products, lotions, and other residues on the skin can quickly degrade water quality.

14

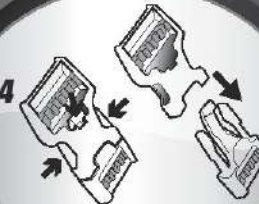

6

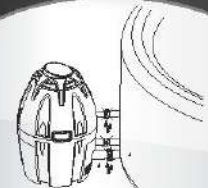

Check and ensure the Spa and adapters are not leaking.

10



All Spas require the use of chemicals in order to keep the water clear and safe.

9



If the pump not heating properly, please press the thermal cut-out manual "Reset" button on the pump.

8



Change the Filter Cartridges regularly

7



Clean and maintain the Filter Cartridge regularly.

# Lay-Z-Spa™

The Comfortable, Affordable, Go-Anywhere Spa!™

## Maintaining Spa Water

Proper disinfection and filtration of spa water kills harmful micro-organisms, removes oils, make up, lotion and ensures the water is clean and safe.

Spa water quality can be extremely hazardous to your health. We recommend you do the following points:

- A. Clean filter cartridges every day and change filter cartridges every week depending on use.
- B. Change water regularly and use appropriate Spa pool chemicals.

**NOTE:** When performing chemical maintenance, activate the Lay-Z-Massage function to quickly dissolve chemicals into the water.

**NOTE:** Remove the chemical floater from spa when the spa is in use.

All spas require the use of pool chemicals. Pool chemicals are potentially toxic and should be handled with care. There are serious health risks from chemical vapors and the incorrect labeling and storage of chemical containers. Please consult your local pool supply retailer for more information about chemical maintenance. Pay close attention to the chemical manufacturer's instructions. Spa damage resulting from misuse of chemicals and mismanagement of spa water is not covered by the warranty.

### 1. Water Balance

We recommend maintaining your water pH between 7.4 and 7.6, total alkalinity between 80 and 120ppm and free chlorine between 2 to 4ppm. Purchase a test kit to test your water chemistry before using the spa and continue to test the water no less than once a week. Low pH will cause damage to the spa and pump. Damage resulting from chemical imbalance is not covered by the warranty.

### 2. Water Sanitation

The spa owner must regularly maintain pool water with scheduled maintenance (daily if necessary).

**Note:** Sanitizers chemically control bacteria and viruses present in spa water.

### 3. The Bestway Lay-Z-Spa is supplied with a chemical floater.

**Please note:** this is supplied for use with chemical tablets only. Do not use granules.

# Lay-Z-Spa Xtras

## Cleaning

